

**WILDLIFE AND COUNTRYSIDE ACT 1981**

**CUMBERLAND COUNCIL**  
**(PARISH OF STANWIX RURAL: DISTRICT OF CARLISLE)**  
**DEFINITIVE MAP AND STATEMENT MODIFICATION ORDER (NO 5) 2024**

The Order is made by Cumberland Council ("the Authority") pursuant to Section 53(2)(b) of the Wildlife and Countryside Act 1981 ("the Act") because it appears to the Surveying Authority that the definitive map and statement for Cumberland require modification in consequence of the occurrence of an event specified in Section 53(3)(c)(i), namely, the discovery of evidence which (when considered with all other relevant evidence available to the surveying authority) shows that a right of way which is not shown in the map and statement subsists or is reasonably alleged to subsist over land in the area to which the map relates, being a right of way such that the land over which the right subsists is a public path, a restricted byway or, subject to section 54A, a byway open to all traffic.

The authority has consulted with every local authority whose area includes the land to which the Order relates.

The Authority hereby order that:

1. For the purposes of this Order the relevant date shall be 1 October 2024.
2. The definitive map and statement for the Cumberland shall be modified as described in the Schedule and shown on the map attached to the order.
3. This Order shall have effect on the date it is confirmed and may be cited as the Cumberland Council (Parish of Stanwix Rural: District of Carlisle) Definitive Map and Statement Modification Order (No 5) 2024.

Dated the 29th day of October 2024

Executed as a Deed by )

Affixing the Common Seal of )

**CUMBERLAND COUNCIL** )

in the presence of:- )

*K. Clark*



<b>SCHEDULE</b>
-----------------

<b>PART 1</b>
---------------

<b>Modification of the Definitive Map</b> Description of public rights of way to be modified
---

References on plan.	Description of length of rights of way to be added.	Width
A-B-C-D	All the strip of land in the parish of Stanwix Rural from Whiteclosegate at grid reference 341178 557965 southeastwards for about 108 metres along an aggregate surface vehicle track to grid reference 341266 557902 then turning southwestwards along a surfaced path for about 71 metres via a pedestrian baffle to Millcroft at grid reference 341223 557846	A-B = 4.2 metres at roadside narrowing to 2.4 metres B-C = 1.7 metres C-D = 1.8 metres

<b>PART 2</b>
---------------

<b>Modification of Definitive Statement</b> New description of path or way.
--

<b>Path Number</b>	132026	<b>Path type</b>	footpath
<b>Width</b>	4.2 metres at grid reference 341178 557965 narrowing to 2.4 metres at 341266 557902 1.7 metres between grid reference 341266 557902 and 341248 557880 1.8 metres between grid reference 341248 557880 and 341223 557846	<b>Length</b>	179 metres
<b>OS Sheet Number</b>	NY 45 NW		
<b>Grid References</b>	341178 557965 to 341223 557846		

<b>Description</b>	From Whiteclosegate along an aggregate surface vehicle track to grid reference 341266 557902 then turning southwestwards along a natural surface path to a pedestrian baffle at grid reference 341248 557880 and continuing on a concrete surfaced path to Millcroft
<b>Limitations and Conditions</b>	None at 2024 modification
<b>Remarks</b>	Added by modification order at Millcroft No 5 2024

Confirmed this 7<sup>th</sup> day of January 2025

Executed as a Deed by )

Affixing the Common Seal of )

**CUMBERLAND COUNCIL** )

in the presence of:- ) Esthansu



DATED

2024

---

**WILDLIFE AND COUNTRYSIDE ACT 1981**

**CUMBERLAND COUNCIL**

(Parish of Stanwix Rural:District of Carlisle) Definitive Map and Statement  
Modification Order (No 5) 2024

Chief Legal Officer  
Resources,  
Cumbria House  
CARLISLE  
CA1 1RZ



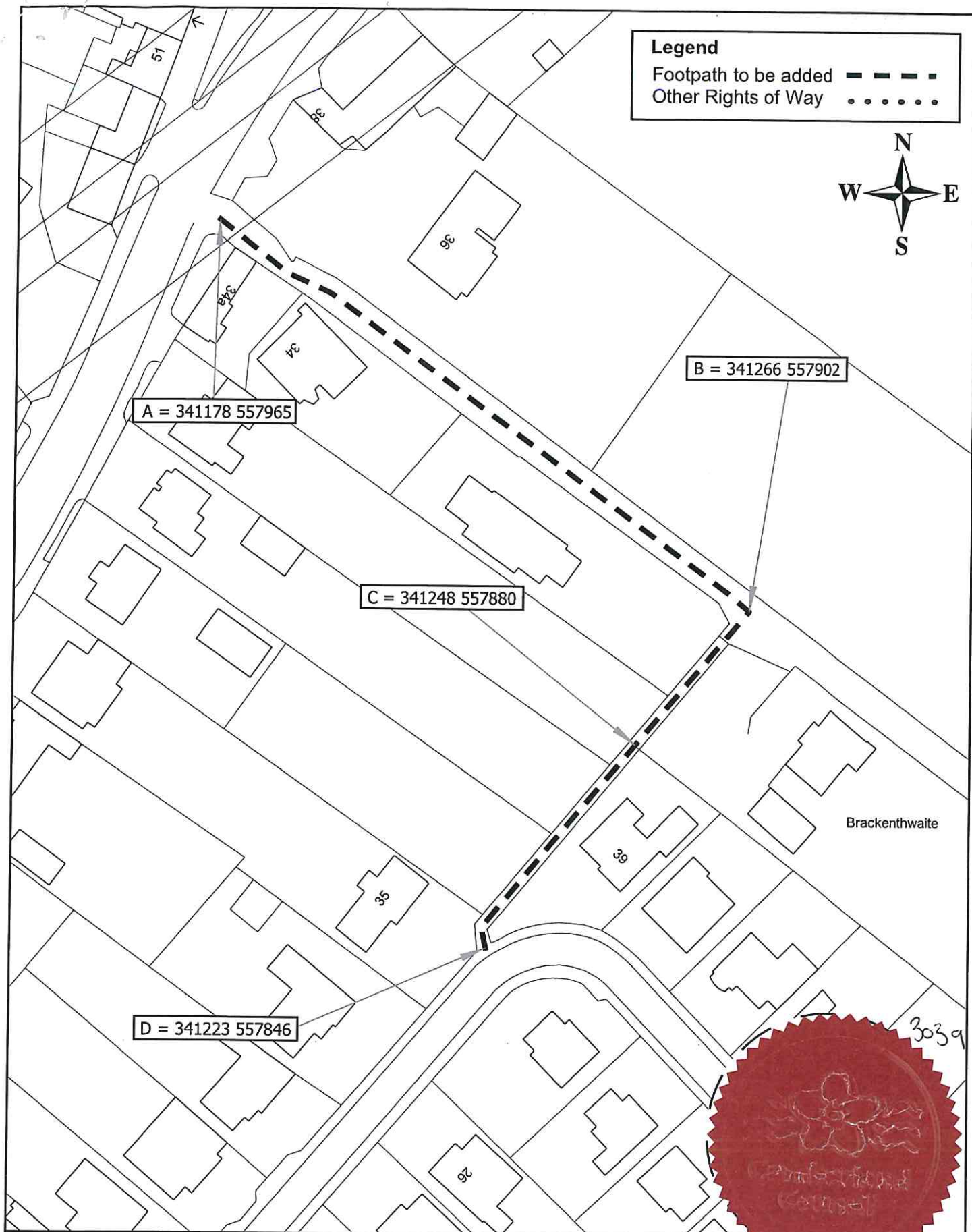

*K. Clark*

